

Join us for the
SNRS 25th Annual Conference:
SNRS: Celebrating 25 Years
of Nursing Research
February 16-19, 2011
Jacksonville, FL

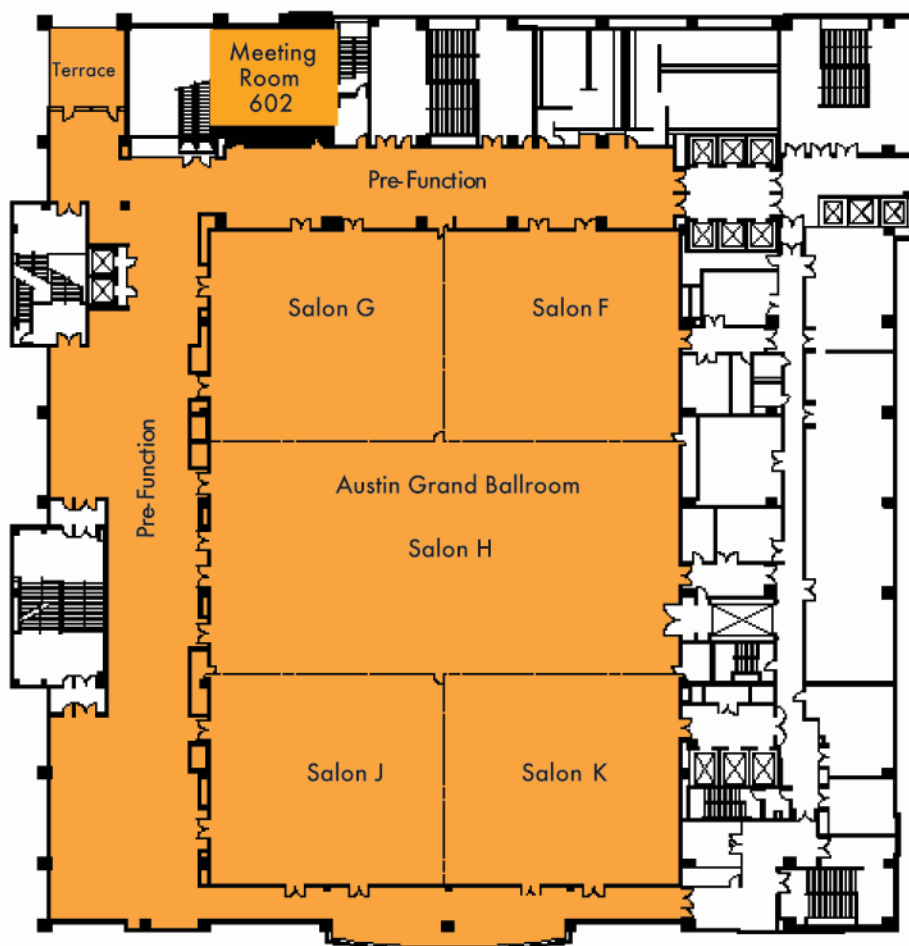

Southern
 Nursing
 Research
 Society

HILTON AUSTIN CONVENTION CENTER HOTEL
 SIXTH FLOOR



HILTON AUSTIN CONVENTION CENTER HOTEL
 FOURTH FLOOR

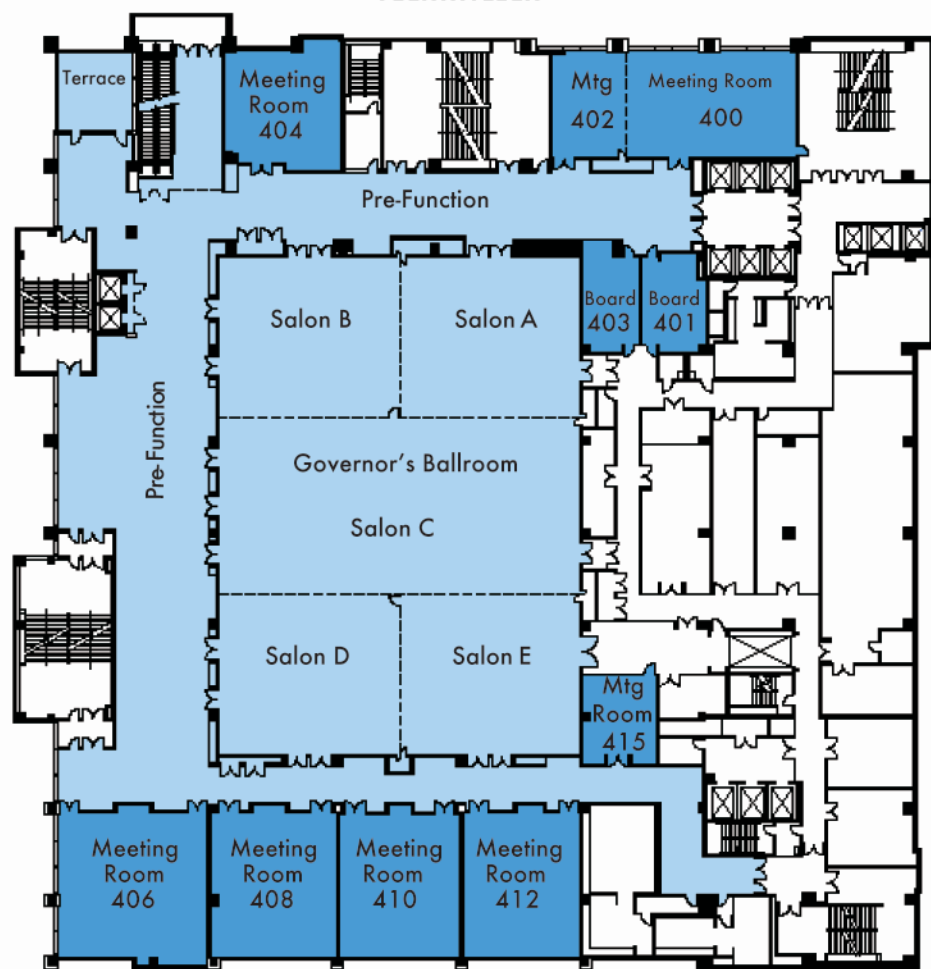

People Places Possibilities

The Johns Hopkins University School of Nursing—
 a place where exceptional
 people discover possibilities that forever
 change their lives and the world.

www.nursing.jhu.edu/possibilities

Visit us at booth 15



JOHNS HOPKINS
 UNIVERSITY

School of Nursing



Austin, TX

24th Annual
 Conference of the
 Southern Nursing Research Society

Health Care Challenges in the Next Decade

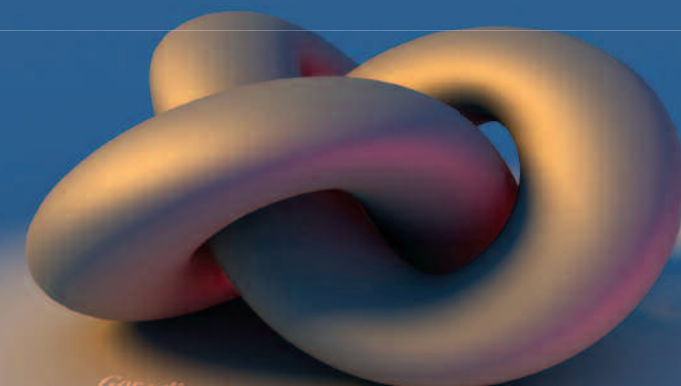

*Gordian knot, gar-dee-an-not, n.
 a legend associated with Alexander
 the Great. It is often used as a metaphor
 for an intractable problem, solved by a
 bold stroke.*

Hosted by
 The University
 of Texas at Austin

February 3-6, 2010

Table of Contents

Local Planning and Program Committees	4
Welcome to 24th Annual SNRS Conference	4
Keynote Speaker	6
Silent Auction	8
SNRS Board of Directors	9
Schedule of Events	10
Pre-Conference Workshops	10
Networking Sessions	10, 20
Welcome/Keynote Address	11
State Liaison Luncheon Meeting	13
RIG Meetings	13, 20, 30
Poster Sessions	14, 24, 32
Plenary: Board Panel Referencing Hearing	20
Opening Reception	20
Plenary Session: NINR Dialogue: Building Nursing Science	21
Funding Panel Breakfast	31
Awards Luncheon	24
Deans and Directors Meeting	20
2010 Conference Sponsors	37
Exhibitors	38
2010 SNRS Award Winners	fold out
Schedule-at-a-Glance	inside back cover

Continuing Education Credits:

This program has been approved by the Alabama State Nurses Association (ASNA) for continuing education credits. ASNA is an accredited approver of continuing nursing education by the American Nurses Credentialing Center's Commission on Accreditation (ANCC). ASNA adheres to the standards and guidelines set forth by ANCC.

This education program offers up to 20.5 nursing contact hours.

SNRS On-site Registration Hours

Wednesday, February 3	7:30 a.m. – 5:30 p.m.
Thursday, February 4	7:00 a.m. – 5:30 p.m.
Friday, February 5	7:00 a.m. – 6:00 p.m.
Saturday, February 6	7:00 a.m. – 12:00 p.m.

Local Planning Committee Members

Sharon D. Horner, PhD, RN, MC-CNS, FAAN

Local Planning Committee Chair
Professor

The University of Texas at Austin

Alexandra García, PhD, RN
Associate Professor

The University of Texas at Austin

Tracie Harrison, PhD, RN, FNP

Assistant Professor

The University of Texas at Austin

Eun-Ok Im, PhD, MPH, RN, CNS, FAAN

La Quinta Motor Inns, Inc. Centennial
Professor

The University of Texas at Austin

Diane Tyler, PhD, RN, CNS, FNP

Professor of Clinical Nursing

The University of Texas at Austin

Deborah Volker, PhD, RN, AOCN

Associate Professor

The University of Texas at Austin

SNRS Program Committee

Anne Turner-Henson, DSN, RN, Chair

SNRS Vice President

Professor

University of Alabama at Birmingham

Sharon Horner, PhD, RN, MC-CNS

Local Planning Chair

Professor

University of Texas at Arlington

Ann Horgas, PhD, RN, FAAN

Associate Professor; Associate Dean for

Research

University of Florida

David Stumph, IOM, CAE

Executive Director

Southern Nursing Research Society

Ann Mehan Crosse

Associate Director

Southern Nursing Research Society

Welcome to the 24th Annual SNRS Conference

The SNRS Board and the Austin, TX Local Planning Committee (LPC) are pleased to present the program for the 24th Annual SNRS Conference, **“Health Care Challenges in the Next Decade.”** The LPC, represented by the University of Texas at Austin School of Nursing faculty, welcomes you to Austin, Texas, the live music capital of the world. Our UT Austin LPC and Program Committee have planned a full conference with scholarly papers, symposia, posters, plenary sessions, experts’ round table meetings, networking sessions, and this year we are debuting poster discussion sessions. This conference was designed to provide participants with a forum for a robust dialogue among colleagues on major research areas, create a forum to mentor and introduce the next generation researcher to the community of scholars and be enriched by the value of networking.

A few highlights:

- The keynote speaker will be **Ada Sue Hinshaw**, PhD, RN, FAAN, Dean and Professor of the Graduate School of Nursing, at the Uniformed Services University. Dr. Hinshaw is a world-renowned researcher. She served as the first permanent director of the National Center of Nursing Research and guided its transition into the National Institute of Nursing Research at the National Institutes of Health. Her research interests focus on nursing staff, quality in client care, economic outcomes, evaluation of practice structures, and evaluation of environments that influence professional practice.
- Back by popular demand, the **Publishing Pre-Conference Workshop** will be held on Wednesday morning, February 3. Dr. Judith Lewis, SOJNR editor, will demystify the publication process; discuss roles and responsibilities in publishing, authorship, pitfalls in publishing and how to select a journal.
- SNRS is launching its inaugural poster discussion format for presenting research. This format combines the classic poster session (author present to answer questions about the study) followed by group discussions by poster authors and other attendees. The podium discussions in these sessions are not presentations of the study, but rather discussions of issues that cut across the group of posters.
- NINR is sponsoring two additional plenary sessions, featuring Dr. Joan Austin presenting the **“NINR Dialogue: Building Nursing Science”** on Friday morning, February 5 and an additional plenary on Saturday morning, February 6 entitled, **“NIH Funding Mechanisms and the New NIH Guidelines.”**
- The SNRS board will host a Referencing Hearing on Thursday,

February 4 from 3:30 – 4:45 p.m. to explore important issues. All members are strongly encouraged to attend this session in order to express your views and concerns. At this referencing hearing we will be discussing issues such as: budget concerns, dues, future conferences, and other organizational issues. Join us at the referencing hearing to help us move SNRS forward into the future.

The SNRS board wishes to thank conference exhibitors, sponsors and contributors to the Silent Auction, as well as the many individuals who participated in the complex process of planning the Annual Conference program. Thank you to SNRS members who served as abstract reviewers, and the many that supported the numerous aspects of planning and executing this annual meeting. We extend a special thank you to the Local Planning Committee members and chair, Dr. Sharon Horner for their hard work.

Next year we celebrate the 25th anniversary of SNRS – February 16 – 19, 2011, in Jacksonville, FL. The University of Florida will serve as our host school, with Dr. Ann Horgas serving as Chair of the 2011 Local Planning Committee. Join us in sunny Florida for this special celebration.

Enjoy your visit to Austin, Texas. From blues to indie rock, country music to jazz, rock en español and more, Austin, Texas is the live music capital of the world. On any given night, within walking distance of the Austin Hilton, the Austin entertainment district offers live music. Austin is home to such famed personalities as The Dixie Chicks, Willie Nelson, Asleep at the Wheel, Stevie Ray Vaughan, Spoon, Ghostland Observatory and many more. Shopping, ideal spots for walking, visiting the LBJ Presidential library, and of course, The University of Texas Longhorns, are just a few exciting sights close to the conference hotel.

Welcome to Austin and to this outstanding conference. We hope that you will be invigorated by the great program and inspired by the opportunity to interact and network with SNRS members. Thanks to each of you for being here and for continuing to be part of the SNRS legacy. We look forward to three wonderful days together.

Elaine Amella, President, SNRS

Sharon Horner, LPC Chair

Anne Turner-Henson, Vice President, SNRS

Keynote Address: Health Care Challenges of the Next Decade

Speaker: Dr. Ada Sue Hinshaw

The Uniformed Services University of the Health Sciences' University President has appointed Dr. Ada Sue Hinshaw as Dean of the Graduate School of Nursing, effective June 23rd, of 2008. Before joining the Uniformed Services University of the Health Sciences, Dr. Hinshaw served as Dean of the School of Nursing, University of Michigan from 1994 through June, 2006, and Professor in the School until her appointment at the Uniformed Services University. While at the University of Michigan, she was selected to serve as the Distinguished Nurse Scholar-in-Residence at the Institute of Medicine, Washington, D.C. from 2006 to 2007.



Dr. Hinshaw has received many awards and honorary doctorates, including the Midwest Nursing Research Society Lifetime Achievement Award, Health Leader of the Year Award from the United States Public Health Service, the Elizabeth McWilliams Miller Award for Excellence in Nursing Research from Sigma Theta Tau, and the Nurse Scientist of the Year Award from the American Nurses Association, Council of Nurse Researchers. She has also received 13 honorary degrees from universities in the United States and Canada. She is the Past-President of the American Academy of Nursing.

In 2005, she received the Distinguished Leader Award from the National Institute of Nursing Research. Dr. Hinshaw is a member of the Institute of Medicine (IOM), a past member of the IOM Council. Recently, she was Vice-Chair of the IOM's report on "Keeping Patients Safe: Transforming the Work Environment of Nurses" and Chair of the Subcommittee for nurse research training in the National Research Council's report on "Advancing the Nation's Health Needs: NIH Research Training Programs". In October 2005, she received the Walsh McDermott Award from the IOM.

Dr. Hinshaw received her PhD and MA in Sociology from the University of Arizona, an MSN from Yale University, and a BS from the University of Kansas.



*For all • an knot, gar dé • an not, n.
• legend associated with Alexander
the Great. It is often used as a metaphor
for an intractable problem, solved by a
stroke.*

Plenary Session – SNRS Board Panel: Referencing Hearing

The SNRS Board of Directors hosts a referencing hearing on Thursday, February 4, to explore important organization issues. All members are strongly encouraged to attend this session. We will be discussing issues such as: budget, dues, future conferences, and other organization issues. Join us at the referencing hearing to help us move SNRS forward into the future.

Plenary Session – NINR Dialogue: Building Nursing Science

Dr. Joan Austin

The objectives of this plenary session are to increase participants' understanding of NINR strategic plan and identify strategies for building nursing scientists. Dr. Austin will lead a discussion with participants to identify ways that NINR can better support the development of nursing scientists and encourage scientific creativity in nursing research. This plenary session is sponsored by NINR.

SNRS 2009 Grant Recipients:

SNRS Dissertation

Martha Biddle, ARNP, CCNA
University of Kentucky, College of Nursing

A Dietary Lycopene Intervention in Patients with Heart Failure

CANS/SNRS Nursing Science Advancement Dissertation

Jada Brooks
Duke University Medical Center

Interactions between Mothers and their Premature American Indian Infants

SNRS Small Grant

Heeok Park, PhD, RN
Florida State University, School of Nursing

Effect of Music on Agitation in Patients with Dementia According to the Severity of Dementia

Support Funding for Nursing Research

The primary mission of SNRS is to support nursing research. To that end, we are continuing, as part of our Annual Conference, a silent auction to generate funds for additional research grants.

Wednesday, February 3

7:30 a.m. – 5:30 p.m.

Drop off donated items at Registration Desk.

Thursday, February 4

7:00 a.m. – 11:00 a.m.

Drop off donated items at Registration Desk.

12:00 p.m. – 7:30 p.m.

Silent Auction Open

Friday, February 5

7:00 a.m. – 2:30 p.m.

Silent Auction Open

4:15 p.m.

Silent Auction
Winners Posted

4:30 p.m. – 6:00 p.m.

Pick up and pay for items at registration

Saturday, February 6

7:00 a.m. – 12:00 p.m.

Final pick up and pay for items at registration

EARN YOUR PHD IN NURSING AT THE UNIVERSITY OF MIAMI

The PhD program at the UM School of Nursing and Health Studies prepares nurse scientists to contribute to the growth of nursing research and scholarship. Students work with renowned faculty in one of the following areas: Health Disparities and Minority Health, HIV/AIDS and Infectious Diseases, Family and Maternal/Neonatal Health, and Patient Safety.

The program offers two curriculums, the 40-credit hour MSN to PhD and the 61-credit BSN to PhD. The School provides attractive incentives to support qualified full-time doctoral nursing students:

- A full tuition waiver
- A research or teaching assistantship providing a \$3,000 monthly stipend (20 hours per week)
- Student health insurance

For comprehensive information, deadlines, and admissions requirements, visit our website at www.miami.edu/sonhs/phd or contact Dr. Gail McCain at 305-284-2601.

UNIVERSITY OF MIAMI
SCHOOL of NURSING
& HEALTH STUDIES



President – Marti Rice,
PhD, RN

University of Alabama at Birmingham

President-elect – Patricia Crane,
PhD, RN, FAHA

University of North Carolina at Greensboro

Vice President – Anne Turner-
Henson, DSN, RN

University of Alabama at Birmingham

At-Large Board Members

Director of Awards

Ann Malecha, PhD, RN,
Texas Woman's University

Director of Communications
Anne Stiles, PhD, RN

Texas Woman's University

Director of Development

Nan Smith-Blair, PhD, RN
University of Arkansas

Director of Grants

Cindy Munro, PhD, RN, ANP-
C, FAAN

Virginia Commonwealth University

Secretary – Elizabeth Reifsnider,
PhD, RN, WHNP, PHCNS-BC

University of Texas Medical Branch

Treasurer – Demetrius Porche,
DNS, PhD, APRN, FAANP,
FAAN

Louisiana State University

Director of Membership

Deborah J. Jones, PhD, RN
University of Texas – Health Science Center

Director of Research Interest
Groups

Jennifer Wenzel, PhD, RN
Johns Hopkins University

Executive Director
David Stumph, IOM, CAE

Associate Director
Ann Mehan Crosse

Thank you to the 2009 – 2010 SNRS Board of Directors

President

Elaine Amella, PhD, GNP-BC,
FAAN

Medical University of South Carolina

President-Elect

Marti Rice, PhD, RN

University of Alabama at Birmingham

Vice President

Anne Turner-Henson, PhD,
DSN, RN

University of Alabama at Birmingham

Secretary

Mona Shattell, PhD, RN

University of North Carolina – Greensboro

Treasurer

Demetrius Porche, DNS, PhD,
APRN, FAANP, FAAN

Louisiana State University

At-Large Board Members

Director of Awards

Ann Malecha, PhD, VRN

Texas Woman's University

Director of Grants

Cindy Munro, PhD, RN, ANP-
C, FAAN

Virginia Commonwealth University

Director of Communications

Anne Stiles, PhD, RN

Texas Woman's University

Director of Membership

Deborah J. Jones, PhD, RN
University of Texas – Health Science Center

Director of Research Interest
Groups

Jennifer Wenzel, PhD, RN
Johns Hopkins University

Director of Development
Mary K. Walker, PhD, RN,
FAAN

Loyola University – Chicago

Executive Director
David Stumph, IOM, CAE

Associate Director
Ann Mehan Crosse

7:30 a.m. – 5:30 a.m.

Registration Open
SALON J FOYER

9:00 a.m. – 12:00 p.m.

Workshop

W1— Publishing your
Research

MR 406

12:00 p.m. – 1:00 p.m.

Lunch on your own

1:00 p.m. – 4:00 p.m.

**Doctoral Student
Workshop:**

W2—Authorship: Your
Rights and Responsibilities

MR 406

4:00 p.m. – 5:00 p.m.

**Networking Session for
Doctoral Students**

7:00 a.m. – 5:30 p.m.

Registration Open
SALON J FOYER

7:30 a.m. – 8:30 a.m.

Continental Breakfast/
Exhibits Open

SALON H / SALON J

7:30 a.m. – 8:30 a.m.

Poster Session I Setup
SALON J

8:00 a.m. – 8:25 a.m.

Room Moderator and
Monitor Orientation

MR 602

8:30 a.m. – 8:45 a.m.

**Welcome/Introduction
by Elaine Amella, SNRS
President**

SALON H

8:45 a.m. -9:45 a.m.

Keynote Address

SALON H

*Sponsored by the Council for the
Advancement of Nursing Science*

*Speaker: Dr. Ada Sue Hinshaw, Dean
and Professor, Graduate School of
Nursing, Uniformed Services University*

9:45 a.m. – 10:15 a.m.

Break/Exhibits Open

SALON H FOYER/SALON J

10:15 a.m. -11:30 a.m.

**Session A1: The
Challenge of Cancer**

MR 400

A1-1 **Biobehavioral Pilot
Study of CES for Symptoms
in Women with Breast
Cancer**—*Debra Lyon*

A1-2 **Promoting Healthy
Behaviors in Low-Income
Cancer Survivors**

—*Martha Meraviglia*

A1-3 **Comorbidity and
Related Predictors of
Decreased Lung Cancer
Survival**—*Yea-Jyh Chen*

A1-4 **Results of a Home-
Based Walking
Intervention for Patients
Undergoing Cancer
Treatment**—*Jennifer Wenzel*

**Session A2:
Methodological
Considerations**

MR 406

A2-1 **Development of a
Lymphedema Symptom
Survey in Head and Neck
Cancer Patients**—*Jie Deng*

A2-2 **Using the Delphi
Method with Internet-
Based Survey Tools in a
Complex Nursing
Competencies Study**
—*Lynne Andrus*

A2-3 **Reflective Journaling:
Preparation of Graduate
Students for Health Care
Challenges in the Next
Decade**—*Gail Williams*

A2-4 **Treatment Fidelity in
Nursing Home Research: A
Case Example of Where We
Are and Where We Need
to Go**—*Elizabeth Galik*

**Session A3: Symposium:
Biobehavioral Markers of
Stress Related Alterations
In Health**

Symposium Leader: Roberta Ruiz

SALON G

A3-1 **Psychoneuro-
immunology: Preterm
Birth in Hispanics**
—*Jeanne Roberta Ruiz*

UF UNIVERSITY of FLORIDA

College of Nursing

The University of Florida is one of the nation's top twenty Association of American Universities (AAU) public research universities and the state's oldest and most comprehensive university.



CARE. LEAD. INSPIRE.

NURSING EDUCATION

Offering innovative program options in graduate study:
- Clinical Nurse Leader, Accelerated BSN to PhD, Doctor of
Nursing Practice and PhD in Nursing Science including a
PhD consortium to transmit classes via distance education to
sites in North Florida

NURSING RESEARCH

The College is one of six in UF's comprehensive **Health
Science Center**. UF College of Nursing faculty researchers
collaborate with more than 40 other programs, institutes and
centers of excellence located within UF. Many of our faculty
researchers are federally funded.

NURSING OPPORTUNITIES

Come join our team of strong researchers, educators and clinicians!
Visit our Web site for faculty career and doctoral student
opportunities.

www.nursing.ufl.edu

A3-2 Response to Migration Stress in Migrant Farmworkers During Pre-Migration—*Evelyn Clingerman*

A3-3 Physiological and Cognitive Stressors Associated with Glucose Regulation in Menopause—*Sharon Dormire*

A3-4 The Associations Between Cognitive Heart Failure Symptom Beliefs and Chronic and Acute Stress Response in Older Adults—*Carol Delville*

Session A4: Growing the Next Generation: Education

SALON F

A4-1 Comparison of Simulation-Based Performance with Metrics of Critical Thinking Skills in Nursing Students—*Laura Fero*

A4-2 A Mentorship Program for Nursing Students in an Associate Degree Program—*Marilyn Baierlipp*

A4-3 Survey of Graduate Student Clinical Preceptors—*Rebecca Wiseman*

A4-4 American Nurses Foundation: 55 Years of Advancing Nursing Science—*Patricia Messmer*

Session A5: Poster Discussion Session 1: Evidence-Based Practice

SALON K

A5-1: The Effect of Iodine Preparations on Type I Collagen and Fibroblast Migration in Dermal Equivalents—*Annette Wysocki*

A5-2: Testing Counseling and Economic Empowerment to Decrease Partner Violence and Improve Mental Health—*Judith McFarlane*

A5-3: Changes in Infant Disposable Diaper Weights Over Time—*Joan Carlisle*

A5-4: GIFTS (Giving Infants and Families Tobacco-Free Starts): A Bundling Approach to Tobacco Cessation for Pregnant Women—*Kristin Ashford*

A5-5: Translating Research into Practice: Decreasing Children's Needlestick Pain—*Angela Green*

A5-6: The Illness Experience of Persons with Parkinson's Disease—*Melinda Hermanns*

A5-7: Effectiveness of a Lethality Assessment Intervention on Repeat, Lethal, and Near Lethal Violence and Women's Health—*Janet Wilson*

A5-8: Caring for Laboring Women with Histories of Childhood Sexual Abuse—*Sarah Furlong*

A5-9: Moving Toward an Earlier Diagnosis of Ovarian Cancer: An Integrated Review of the Literature—*Sandra Cesario*

A5-10: MESA Interventions in a Nursing Research Course Improved Evidence-Based Practice (EBP) Readiness in Undergraduate Students—*M. Danet Lapiz-Bluhm*

A5-11: Use of Rogers' Diffusion of Innovations Theory to Examine Adoption of Evidence-Based Guidelines for the Prevention and/or Management of PONV/PDNU—*Vallire Hooper*

A5-12: Evidence for Memory Training with Community Elders—*Graham McDougall, Jr.*

A5-13: Safe Patient Handling and Movement Program: Evidence-Based Culture Change through Failure of Body Mechanics and Musculoskeletal Disorders (MSDS) to Nursing Staff—*Constance Ward*

A5-14: The Evidence-Based Practice of Health Literacy Assessment by Rural Nurses—*Brenda Matzke*

A5-15: Early Recognition and Intervention of Sepsis: Implementation of an Early Goal-Directed Protocol in the Emergency Department—*Hope Moser*

A5-16: An Overview of Alternative to Discipline Programs for Nurses from Across the United States—*Phyllis Tipton*

A5-17: Post Discharge Nausea and Vomiting (PDNU) in Ambulatory Surgical Patients: Incidence and Management Strategies—*Jan Odom-Forren*

A5-18: Hospital-Based Smoking Cessation Interventions for Patients Admitted with Respiratory Diseases: An Integrative Literature Review—*Sharon Bennett*

A5-19: Nurses' View of Patient Education Documentation—*D. Stephenson*

A5-20: A Grounded Theory of Filipino Nurses' Role Performance in U.S. Hospitals—*Li-Chen Lin*

A5-21: Organizational Determinants of Quality Care and Nurse Outcomes among Army Medical Department (AMEDD) Registered Nurses (RNs)—*Patricia Patrician*

A5-22: Verbal Abuse of Nurses by Patients and Families—*Myra Goldman*

A5-23: Pay Now or Pay Later: How to Write Right Documentation—*Phyllis Knight-Brown*

11:30 a.m. - 12:30 p.m.

Lunch on your own

11:30 a.m. - 12:30 p.m.

State Liaison Luncheon Meeting

MR 415

RIG Luncheon Meetings

Pick up box lunches in Salon H Foyer

Community/Public Health

MR 406

Education

SALON F

Parent-Child

SALON G

Psychiatric/Mental Health

MR 400

Psychometric

SALON H

Biobehavioral

SALON K

11:30 a.m. - 1:30 p.m.

Exhibits Open

SALON J

12:00 p.m. - 7:30 p.m.

Silent Auction Opens

SALON J FOYER

12:30 p.m. - 1:30 p.m.

Poster Session I with Authors

(* after author denotes Student Poster)

SALON J

P1-1: Psychometric Properties of the Depression, Anxiety, and Stress Scale (DASS-21) in Young Adult College Students—*Jihan Mahmoud*

P1-2: Exploratory Instrument Development of the Supportive Needs of Adolescents Questionnaire: Breastfeeding—*Jane Grassley*

P1-3: Psychometrics of Dysmenorrhea Self-Care Strategies Questionnaires—*Chen Lu**

P1-4: Development and Use of Checklists for Monitoring Quality, Fidelity, and Dosage of Data Collection and Intervention Delivery—*Gwendolyn Cook*

P1-6: Development of a Measurement Model of Proactive Parental Participation in Child Mental Health Care—*Caroline McKinnon**

P1-7: The Children's Computerized Physical Activity Recall (C-CPAR): Test-Retest Reliability and Usability in a Diverse Group of 7th-9th Grade Adolescents—*Patricia Pearce*

P1-8: Assessing and Reporting Inter-Method Agreement—*Benjamas Suksatit**

P1-9: Systematic Review of Research Studies with the Sexual Relationship Power Scale—*Yui Matsuda**

P1-10: Elder Risk Behavior: Psychometric Evaluation of Tower of Hanoi and Balloon Analogue Risk Task in an Aging Sample—*Kathy Daniel*

P1-11: Psychometric Testing of the Wang-34 Scale among Pregnant Women in West Virginia—*Janet Wang*

P1-12: Measuring Beliefs about Breast Cancer Screening among Women With Chronic Disabling Conditions—*Ana Todd**

P1-13: Women's Recovery Experiences of Augmentation, Reduction and Reconstruction Breast Surgery—*Deborah Mayer*

P1-14: Model of Long-Term Breast Cancer Survival in African American Women—*Yvonne Ford**

P1-15: Do Fruits and Vegetables Reduce Depressive Symptoms in Pregnant Women?—*Wendy Pittman**

P1-16: Self-Efficacy and Weight Management in Overweight Premenopausal Women: A Conceptual Framework—*Claudia Bouhaidar**

P1-17: Experiences of Maternal Happiness during Postpartum—*Ching-Yu Cheng**

P1-18: Postpartum Depression in Previously Infertile Mothers: The State of the Science—*Sigrud Ladores**

P1-19: Photovoice: Women's Stories—*Catherine Levonian*

P1-20: The Experience of Being a Woman of Childbearing Age in Mbarara, Uganda—*Bonnie Pope**

P1-21: Effects of the Women's Health Initiative on Hormone Therapy Use in African American Women—*Catherine Greenblum**

P1-23: It Was Weird not Being Able to do Things: Women's Symptom Experience of Ischemic Stroke. Preliminary Findings—*Claudia Beal**

P1-24: Knowledge and Attitudes about Pharmacogenetic Testing among Nurses—*Crystal Dodson**

P1-25: Identifying Attributes of Nursing Clinical Credibility—*Claudia Smith**

P1-26: The Minority Nurse Leader—*Daphne Brewington**

P1-27: The Historical 'Story' of Story Theory for Nursing Practice and Research with a Vision for the Next Chapter—*Allison Edmonds**

P1-28: Establishing Consensus for Evidence-Based Practice Competencies in Associate Degree Programs—*Paula Clutter*

P1-29: Reducing Standard Work to Increase Nursing Care Time in a Clinic Setting—*Sheila Roszell*

P1-30: 2008 RN/BSN Survey of Future Students—*Janice Floyd**

P1-31: An Undergraduate Nursing Student's Collaborative Summer Study on the Role of 5-HT_{2A} Receptor in Cognition—*Ayomide Okanlawon**

P1-32: The Utilization of Simulation in a Clinical Child Health Nursing Course: Student Perceptions of Faculty Led Simulation—*Jacquelyn Reyna-Stovall**

P1-33: Using Distance Technology to Deliver Asthma Education to School Nurses in an Appalachian Area: ADEP (Asthma Distance Education Program)—*Susan Pinto**

P1-34: Assessing the Accuracy and Precision of Ankle-Worn Accelerometers in Persons at Risk for Pressure Ulcers—*Mary Pat Rapp*

P1-35: African American Men with Hypertension: Exploring Beliefs and Attitudes about Medication Adherence Between the Ages of 45-65 with High Blood Pressure—*Janell Bennett**

P1-36: Pilot Study: Could the Geriatric Depression Scale be Used to Assess Prevalence of Depression among Filipinos Attending a Community Fiesta?—*Teck Tan**

P1-37: Transition of Pediatric Renal Transplant Recipients to Adult Providers: A Systematic Review of the Literature—*Bethany Coyne**

P1-38: Gender Differences in Psychological Symptoms of Implantable Cardioverter Defibrillators Patients—*Adam Houck**

P1-39: Endorsement of Anger by Patients Living with Chronic Back Pain—*Ann Quinlan-Colwell*

P1-40: Pathophysiological Mechanisms of Fibromyalgia: Current Theories and Evidence—*Zahra Tashakkori**

P1-41: Caregiver Perceptions of Factors Contributing to Resident-to-Resident Violence in Nursing Homes—*Susan Sifford**

P1-42: Using Cultural Immersion to Inform Research Methods with Immigrant Populations—*Christina Hernandez**

P1-43: A Review of the Literature Identifying Factors Influencing the Implementation of an HPV Prophylaxis Program—*Deborah Baptist**

P1-44: The Changing Face of Sickle Cell Disease: Older Adults Express Successful Aging through Life Review—*Ashley Leak**

P1-45: Predicting Feeding Success in Preterm Infants—*Rita Pickler*

P1-46: The Effects of Severity of Illness on Length of Stay and Time to Age at Full Feedings—*Deborah Fisher**

P1-47: Ethnic Minority Mothers' Parenting Behaviors Toward their Premature Infants—*Jada Brooks**

P1-48: The Effect of Perceived Stress and Sleep Disturbances on Well-Being of Postpartum Women with an Infant in NICU—*Janeen Amason**

P1-49: Perceived Maternal Competence and Psychosocial Adaptation: Difference between Primiparous and Multiparous Mothers in Taiwan—*Hsiu-Rong Cheng**

P1-50: Late Preterm Infant Maternal Competence: A Conceptual Model—*Brenda Baker**

P1-51: Investigating the Relationship Between Acculturation, Preterm Birth, and Local Inflammatory Responsiveness—*Janiece Walker**

P1-53: Lifestyle Behaviors and Illness-Related Factors as Predictors of Recurrent Headache in US Adolescents—*Suzy Mascaro Walter**

P1-54: The Meaning of Being in Romantic Relationships for Young Adult At-Risk Males—*Jennifer Collins**

P1-55: Health-Related Quality of Life in Adolescents and Young Adults with Cancer: A Systematic Review of the Literature—*Tara Albrecht**

P1-56: Adolescent Suicide Prevention Measures: An Evidence Based Review—*Ali Shropshire**

P1-57: Rural School-Aged Children's Asthma Coping—*Sharon Horner*

P1-58: Biochemical Response to Stress in Children—*Carlee Lehna*

P1-59: Does Sleep Matter to Mothers with a Low Birth Weight Infant?—*Sarah Harris**

P1-60: Knowing the Pediatric Patient through Nursing Documentation—*Tiffany Kelley**

1:30 p.m. – 3:00 p.m.

Session B1: Poster Discussion Session 2: Pick of the Litter
(*Doctoral Student Posters)

SALON K

B1-1: The Meaning of Adolescents' Eating Experiences during Bone Marrow Transplant Recovery—*Cheryl Rodgers**

B1-2: Preliminary Development of an Eating Assessment Tool for Young Children: Establishing Content Validity Using an Expert Panel—*Jinhee Park**

B1-3: Markers of Cardiovascular Risk in African-American Adolescents—*Elizabeth Lee**

B1-4: Short-Term Effects of a Nutrition Education Program on Food Choices in Adolescents at Risk for Type 2 Diabetes—*Melissa Ethington**

B1-5: Electrocardiogram Screening for Cardiovascular Risk Factors in Overweight-Obese Youth with Prediabetes and Elevated Blood Pressure—*Shirleatha Lee**

B1-6: The Lived School-Based Experiences of Being an Adolescent with Type 1 Diabetes: A Pilot Study—*Yueh-Ling Wang**

B1-7: The Mother-Daughter Bond: A Key to Promoting Physical Activity in Adolescent Girls—*Wanda Thompson**

B1-8: Parental Experiences of Transitioning Their Adolescent with Epilepsy and Cognitive Impairments from Pediatric to Adult Health Care—*Rebecca Schultz**

B1-9: Ethical Issues for Families Living with Sickle Cell Disease—*Cheryl Brewer**

B1-10: Interviewing Parents about Sensitive Topics—*Kimberly Allen**

B1-11: Knowledge: A Predictor of Folic Acid Intake in North Carolina College Students—*Susan Lane**

B1-12: A Secondary Data Analysis of Smoking Status, Everyday Stressors, and Social Support Throughout Pregnancy—*Emily McMahan**

B1-13: Measuring Maternal Stress and Its Effect on Birth Outcomes—*Christin Huff**

B1-14: Intrapartum Nurse's Experience of Supporting Women Who Anticipate the Birth of a Preterm Infant—*Suzanne Lundeen**

B1-15: Nurses Intent to Respond to Calls for Emergency Service During Hurricane Ike—*Paula Stangeland**

B1-16: Online Social Networking and Diabetes—*Ryan Shaw**

B1-17: What Ethical Issues Arise Regarding Breast Cancer Genetic Testing Within the Context of Family?—*Shalonda Horton**

B1-18: Critical Care Nurses' Perceptions and Knowledge of Patient Confidentiality—*Angela Newman**

B1-19: Our Journey to Eliminate VAP—*Cheryl Rogers**

B1-20: The Prevalence of Stress Fractures and Risk Factors among US Army Recruits by Race and Gender—*James Post**

B1-21: Predictors of Nurses' Behavioral Intention to Disinfect Needleless Intravenous Systems—*Judy Smith**

B1-22: Anxiety Predicts Shorter Event-Free Survival Only among Heart Failure Patients with Co-Existent Depressive Symptoms—*Mona Abed**

B1-23: Psychometric Properties of the Patient Health Questionnaire-9 in Heart Failure Patients with Chronic Constipation—*Eun Jin Lee**

B1-24: Barriers to Health-Promoting Behaviors in Cancer Survivors with Pre-Existing Disabling Conditions—*Sook Jung Kang**

B1-25: Characterizing Dietary Intake Associated with Weight Gain in Persons Post Kidney Transplant—*Connie Cupples**

B1-26: Depressive Symptoms Mediate the Relationship between Health-Related Quality of Life and Cardiac Event-Free Survival—*Kyoung Suk Lee**

B1-27: Improving Adherence in African American Women with Primary Hypertension—*Danice Greer**

B1-28: An Emergency Department Patients' Perception of Safety—*Paul Clark**

B1-29: Epiphanies and Wellness: The Lived Experience—*Jenifer Chilton**

B1-30: Does a Stressful Night Shift on the Floor Make You Fat? An Examination of Association Between Shift, Unit, and Stress and the Incidence of Obesity among RNs—*Kristen Barbee**

B1-31: Shifting Paradigms: The Development of Nursing Identity in Foreign-Educated Physicians Retrained as Nurses Practicing in the United States—*Liwliwa Villagomez**

Session B2: Healing the Hearts

SALON G

B2-1: Longitudinal Changes in Psychologically Distressed Post Myocardial Infarction Patients and Spouses in the Home Automatic External Debrillator Trial (HAT)—*Erika Friedmann*

B2-2: Women with Lupus are Unaware of Their Cardiovascular Risk Factors and Increased Risk for Heart Disease—*Patricia Weinstein*

B2-3: Post Myocardial Infarction Physiological Factors Predict Cardiac-Related Hospital Readmissions—*Patricia Crane*

B2-4: Depressive Symptoms and Poor Social Support Have a Synergistic Effect on Event-Free Survival in Patients with Heart Failure—*Misook Chung*

Session B3: Nursing Interventions to Improve Health

SALON F

B3-1: Identifying Challenges for Effective Delivery of SIDS Education and Outreach among African American Women in Two Mississippi Communities—*LaDonna Northington*

B3-2: Maintaining Proficiency in CPR—*Carolyn Cason*

B3-3: Informal Caregiver Training Prior to Hospital Discharge of Cancer Patients—*Cristina Hendrix*

B3-4: Reduced Vaginal Douching Following an Educational Intervention: Preliminary Results—*Hayley Mark*

B3-5: Saving Backs & Bucks: Implementing a Minimal Life Program—*Fern Hannigan*

Session B4: Qualitative Research

MR 406

B4-1: Understanding of Advance Care Planning by Family Members of Persons Undergoing Hemodialysis—*Amy Calvin*

B4-2: Buffering Low Health Literacy: Health Care Provider Partnering with Mexican-American Cancer Caregivers—*Carolyn Spence Cagle*

B4-3: A Qualitative Study of the Role of Spirituality among Retired Military Nurses—*Irene Gilliland*

B4-4: Making Sure: Registered Nurses Watching Over Their Hospitalized Patients—*Lee Schmidt*

B4-5: Understanding Health Challenges of Older Adults Undergoing Hemodialysis as Evidence for Self-Management Strategies to Promote Health—*Debra Hain*

Session B5: Symposium: Conducting Research in School Settings: Issues, Challenges, and Strategies

Symposium Leader: Marti Rice

MR 400

B5-1: Asthma Health Education and Counseling Research in Midwestern Urban School Districts—*Eileen Kintner**

B5-2: Fitting an Asthma Self-Management Program into Rural School System Restrictions—*Sharon Horner*

B5-3: The Practice-Based Research Network as a Model for Advancing Research and EBP in School Settings—*Judith Vessey*

B5-4: Addressing Challenges of a Child Anger Intervention Using Cognitive/Behavioral and Physical Activities Strategies in a Southeastern Rural School District—*Marti Rice*

3:00 p.m. – 3:30 p.m.

Break / Exhibits Open
SALON H FOYER/SALON J

3:30 p.m. – 4:45 p.m.

Plenary Session – SNRS Board Panel: Reference Hearing

SALON H

Membership input is sought on topics that are slated for discussion and vote at the

Annual Business Meeting on Friday. All members are strongly encouraged to attend.

4:45 p.m. – 5:30 p.m.

Networking Sessions

Deans & Directors

MR 400

Meet the Editors

MR 406

4:45 p.m. – 5:30 p.m.

RIG Meetings

Aging

SALON F

Health Promotion

SALON G

Researchers in Clinical Settings

SALON K

Evidence-Based Practice

BD 403

Qualitative

MR 602

4:45 p.m. – 7:30 p.m.

Exhibits Open

SALON J

6:00 p.m. – 7:30 p.m.

Opening Reception

SALON H

7:30 p.m. – 8:30 p.m.

Tear Down Poster Session I

SALON J

7:30 p.m.

Dinner on your own

7:30 p.m.

RIG Leadership Dinner Meeting Offsite

7:00 a.m. – 6:00 p.m.

Registration Open

SALON J FOYER

7:30 a.m. – 8:00 a.m.

Poster Session II Setup

SALON J

7:30 a.m. – 8:00 a.m.

Room Moderator and Monitor Orientation

MR 602

7:30 a.m. – 8:15 a.m.

Continental Breakfast / Exhibits Open

SALON H / SALON J

8:15 a.m. – 9:15 a.m.

Plenary Session: NINR Dialogue: Building Nursing Science

SALON H

Speaker: Dr. Joan Austin

9:20 a.m. – 10:45 a.m.

SNRS Annual Business Meeting

SALON H

All SNRS members are strongly encouraged to attend.

10:45 a.m. – 11:00 a.m.

Break / Exhibits Open

SALON H FOYER / SALON J

11:00 a.m. – 12:30 p.m.

Session C1: Improving Nurse Practice

SALON F

C1-1: Role Preference Characteristics in Adults with Asthma—*Tracy Estes*

C1-2: A National Study to Compare the Tolerability and Effectiveness of Colon Cleansing Preparations

—*Glenda Daniels*

C1-3: Career Transition Theory and Nurse Executive/Manager Job Loss—*Theresa Carroll*

C1-4: Oropharyngeal Secretion Removal in Intubated Patients—*Mary Sole*

C1-5: Autonomy, Self-Efficacy, Influence of Leadership Behaviors, and Shared Governance as Predictors of Registered Nurse Job Satisfaction in an Acute Healthcare System—*Kenn Kirksey*

Session C2: Overcoming Neonatal Challenges in Life

MR 408

C2-1: Feeding Fatigue in Preterm Infants—*Rita Pickler*

C2-2: Gender Effects on the Health and Development of Medically At-Risk Infants—*June Cho*

C2-3: Non-Nutritive Sucking for Preterm Infants in Egypt—*Heba Kamhawy*

C2-4: The Effect of Early Versus Late Start of Minimal Enteral Nutrition on Selected Clinical Outcome Measures of the Parenterally Fed Preterm/Very Low Birth Weight Infants—*Rabab Hassan*

C2-5: The Effect of Cycled Light on Time to Full Enteral Feedings in Premature Infants—*Heather Mann*

**Session C3: Symposium:
Health Promotion: A
Catalyst to Enhance
Quality of Life in Persons
Living with Chronic
Disabling Conditions**

Symposium Leader: Alexa Stuitbergen

SALON G

C3-1: What do We Really Know? The Evidence for Health Promotion Interventions for Persons with Chronic and Disabling Conditions, 1990-2007

—Alexa Stuitbergen

C3-2: Methodological Procedures for Qualitative Cross Cultural Analysis for Health Promotion Intervention

—Tracie Harrison

C3-3: Factors Contributing to Health Promotion among Cancer Survivors with Pre-Existing Disabling Conditions—Heather Becker

C3-4: Unintended Consequences: The Impact of Social Relationships on Outcomes of a Health Promotion Intervention for Women with Fibromyalgia Syndrome—Claudia Beal

Session C4: Biobehavioral Perspectives

MR 400

C4-1: Actigraphy and Patient Movement: Testing a New Application—Mary Jo Grap

C4-2: Biobehavioral Relationships in Fibromyalgia—Victoria Menzies

C4-3: Exploration of Porcine Stress-Hormone Response to Critical Care

—Sandra Hanneman

C4-4: Smoker Vulnerability to Infection: Using Immune Cells in a Bench Science Approach—Alison Montpetit

Session C5: Poster Discussion Session #3 – Late Breakers

(* after author denotes Student Poster)

SALON K

C5-1: The Impact of Verbal Abuse Experienced by Patient Care Nurses—Tanya Judkins-Cohn

C5-2: Staff Nurse Perspective of Workplace Incivility—Patricia Lewis

C5-3: Acts of Caring: Nurses Caring for Nurses—Joy Longo

C5-4: NCLEX Success: Are There Predictors?—Thayer McGahee

C5-5: Physical and Psychological Aspects of Palliative Care in the National Consensus Project and National Quality Forum Preferred Practices: A Nursing Perspective—Hyejin Park

C5-6: Instrument Development/Testing the Marginality Index—Anne Koci

C5-7: Intravenous Administration Issues: A Comparison of Peripheral Intravenous Catheter Complications in Vancomycin vs. Other Antibiotics—Sheila Roszell*

C5-8: Insight into ICU Nurses' Experiences in Providing Terminal Care—Laura Espinosa

C5-9: The Role of Pain, Analgesia and Insulin in Falls among Hospitalized Patients—Ann Quinlan-Colwell*

C5-10: A Pilot Study: Establishing the Prevalence of Acute Delirium and Evaluating the Feasibility and Effectiveness of a “Bundle” for Prevention in Adult Critically Ill Mechanically Ventilated Patients—Jan Foster

C5-11: Smoking Cessation Stages of Change among College Smokers and Tobacco Marketing—Lee Ridner

C5-12: Promoting Health and Wellness in the Borderlands: Perspectives on the Incorporation of Exercise into the Lives of Latinas in the South Carolina Midlands and Texas Border Communities—DeAnne Hilfinger Messias

C5-13: A Study of Longitudinal Data Examining Concomitance of Pain and Cognition in an Elderly Long-Term Care Population—Allison Burfield

C5-14: The Effect of Music on Pain for Home-Dwelling Persons with Dementia—Heek Park

C5-15: Factors Associated with Quality of Life in the Elderly—Marianne Baernholdt

C5-16: Linking Postpartum Depression and Violence: The Experience of Chilean Women—Ana Maria Quelopana

C5-17: Test of a Feeding Protocol for Preterm Infants with Bronchopulmonary Dysplasia (BPD)—Gail McCain

C5-18: Long-Term Effects of Cycled Light and Near Darkness on Preterm Infants Neurodevelopmental Outcomes—Debra Brandon

C5-19: Eye Examinations for Retinopathy of Prematurity: Do Infants Suffer Adverse Effects?—Anita Mitchell

C5-20: Examining Factors that Increase and Decrease Stress in Adolescent Community College Students—Nancy Ahern

C5-21: Breast Cancer in the Context of an Abusive Intimate Partner in Older Women—Erika Sawin

C5-22: Current Pain Management Issues among Direct Care Nurses—Kelly Allred

C5-23: Women and Stroke Knowledge in North Carolina—Kathleen Ennen

Session C6: Symposium: Innovative Use of Single Subject Experimental Methods in Clinical Research

Symposium Leader: Jennifer Elder

MR 404

C6.1: Exercise Training in Heart Failure Using Innovative Application of Single Subject Methodology—Andrea Boyd

C6.2: Evaluating Self-Performed Acupressure for Sleep and Chronic Pain in Older Adults Using Single Subject Experimental Methodology—*Margaret Burns*

C6.3: Single-Case Experimental Design in Evaluating Drug Effects on Behavior in Children—*Tina Alessandro*

C6.4: Using Single Subject Research Methodology to Assess the Feasibility of Delivering Acupressure Intervention to Older Adults—*Saunju Yoon*

12:30 p.m. – 2:00 p.m.

Awards Luncheon

SALON H

25th Anniversary Conference 2011:

Invitation to Jacksonville

SNRS Grant Recipients

D. Jean Wood Nursing Scholarship Award

SNRS Award for Research in Minority Health

SNRS John A. Hartford Foundation Geriatric Research Award

SNRS Distinguished Researcher Award

Leadership in Research

Student Poster Awards

2:00 p.m. – 2:45 p.m.

Poster Session II with Authors

(* after author denotes Student Poster)

SALON J

PII-1: The Effect of Self-Concept, Physical Activity, and Screen Time on Blood Pressure and Heart Rate in 11-12 year old Middle School Children—*Elizabeth Gullede**

PII-3: Childhood Under Nutrition: Predictors of Poor Nutrition Status that Shape Clinical Interventions—*Katherine Mariategui**

PII-4: Factors Related to Cardiovascular Health in Young Adult College Males—*Demetrius Abshire**

PII-5: It Drives Us to do It: Pregnant Adolescents Identify Drivers for Sexual Risk-Taking—*Tammy Jones**

PII-6: Adolescents' Quality of Life after Heart Transplant—*Angela Green*

PII-7: A Grounded Theory Study of Substance Use Patterns among Homeless Youth—*Philisie Washington**

PII-8: Disparities in Local Smoke-Free School and Manufacturing Policies in Kentucky—*Amanda Fallin**

PII-9: Depression, Stress, Tobacco Dependence and Cessation—*Gia Mudd*

PII-10: Exposure to Secondhand Smoke, Home Smoking Policies, and Support for Smoke-Free Policy Over Time—*Ellen Hahn*

PII-11: Pharmacotherapy Prescribing Practice for Tobacco Cessation: Analysis of Two Academic Medical Centers—*Janie Heath*

PII-12: Predictors of Academic Achievement in Freshman Nursing Students—*Hsing-Mei Chen*

PII-13: Nursing Students' Perceptions of Peer Caring: RN-BSN versus Generic BSN Students—*Deonna Tanner**

PII-14: Blended vs. Lecture Learning: Outcomes for Staff Development—*Heidi Sherman**

PII-15: Establishing REV-UPN to Ease the BSN Nursing Shortage—*Myrna Armstrong*

PII-16: Effectiveness of an Evidence-Based Information Literacy, Nursing Informatics, and Information Technology Educational Intervention for Nurses—*Heather Carter-Templeton**

PII-17: How Cultural Issues are Reflected in a Pre-Licensure Baccalaureate Nursing Program: A Case Study—*Mona Shattell*

PII-18: Learning with Standardized Patients: Skill Acquisition and Transfer in Nurse Practitioner Students—*Tonya Rutherford-Hemming**

PII-19: Correlates of Frailty in Older Adults Undergoing Cardiac Surgery—*Deborah Lekan**

PII-20: Memory Function among Taiwanese Older Adults—*Wen-Miao Liu*

PII-21: Factors Associated with Risky Sexual Behaviors in Older Adults—*Victoria Foster**

PII-22: Surveillance Robots: Augmenting Home Care of Frail Older Adults—*Heather Sobko**

PII-23: Stress Effects on Immune Function of Spousal Caregivers—*Kathleen Murphy*

PII-24: Geriatric Case Manager Caregiver Interventionist: Key Role Processes—*Elizabeth Hall**

PII-25: A Comparison of the Health, Lifestyle Practices, Health Beliefs and Family Support of African Americans and Afro-Caribbean Elders Living in South Florida—*Florence Keane*

PII-26: Stressors of Family Caregivers of Wounded Warriors—*Denise Miner-Williams*

PII-27: Assessment of Family Quality of Life among Families with a Member who has Cancer—*Panarut Wisawatapnimit*

PII-28: Supporting Families of Intensive Care Patients: A Review of the Evidence—*Elizabeth Van Horn**

PII-29: Concept Analysis: Urgency—*Jennifer Lester*

PII-30: Diaphragm Fatigue in the Prevention and Treatment of Emphysema—*Nan Smith-Blair*

PII-31: Use of Essential Oils to Treat MRSA in End of Life: A Case Study—*Irene Gilliland*

PII-32: Exhaled Gas Analysis of Mechanically Ventilated Subjects—*Alison Montpetit*

PII-33: Effects of Massage on AML Treatment-Related Symptoms and Health-Related QoL—*Audrey Snyder*

PII-34: An Ethnogeriatric Study of Pain Perception in Minority Individuals—*Gretchel Gealogo**

PII-35: Preventing HIV Transmission: Use of the Natural Helper Model to Impact Sexual Self-Efficacy among African American Men—*Tiffany Scott**

PII-36: Experiences of Aging among Gay Men—*Eric Fenkl**

PII-37: Personal and Work-Related Factors Contributing to Back Pain in Firefighters—*Mantana Damrongsak*

PII-38: Psychosocial Correlates of Diet Quality in Working Adults—*Erin Ferranti**

PII-39: Integrative Biopsychosociospiritual Care Approach for Adults with Sickle Cell Disease: Relationships among Spirituality, Self-Efficacy and Quality of Life—*Maxine Adegbola*

PII-40: Angina Symptom-Related Correlates of Sleep Disturbances in Patients with Coronary Artery Disease—*Laura Kimble*

PII-41: Access to a Home Monitor and Hypertension among Mexican-American Women: A Randomized, Controlled Trial—*Evangelina DeLeon**

PII-43: Mexican Immigrants Living with Hypertension—*Donelle Barnes*

PII-44: African American Women Living with HIV: A Qualitative Perspective on Facilitators of Self-Care—*Kimberly Adams Tufts*

PII-45: Social Support and Maternal Competence of Taiwanese Postpartum Mothers with or without Fatigue—*Ching-Yu Cheng*

PII-46: Public Response to the Suggestion that Providers Suffer after a Medical Mistake—*Erica Lewis**

PII-47: Genetic Ancestry Estimates of Complex Diseases: Study Design Considerations—*Theresa Wadas**

PII-48: The Importance in Distinguishing Between Clinical and Statistical Significance—*Matthew Hayat*

PII-49: Process for Developing a Relational Database Used to Track, Monitor, and Collect Data for a Level III RCT—*Michelle Solitaire*

PII-50: Interventionist Training to Promote Fidelity to Motivational Interviewing—*Peggy El-Mallakh*

PII-51: Interviewing the Oldest Old: A Call for Standardized Methods—*Diana Pierini**

PII-52: Iterative Process of Designing Research Materials to Achieve Visual Recognition—*Eileen Kintner*

PII-53: Building Partnerships in Urban Communities through Focus Groups—*Deborah Jones*

PII-55: The Use of Cognitive Interviews in Strengthening the Content Validity of the Eating Assessment Tool (EAT)—*Holly Wei**

PII-56: Biological Correlates of Mindfulness Meditation: An Integrative Review—*Denna Chaber**

2:30 p.m.

Silent Auction Closes

SALON J FOYER

2:45 p.m. – 4:15 p.m.

**Session D1:
The Challenge of
Responding to Disasters**

SALON F

D1-1: Human Factors as a Key Component in Mass Casualty Response—*Joan Culley*

D1-2: Into the Unknown: Military Nurses' Experiences in Disaster Response—*Felecia Rivers*

D1-3: Can We Do This Again? Coastal Louisiana School Nurses' Adaptations to Hurricanes Gustav and Ike, Three Years after Hurricanes Katrina and Rita—*Lisa Broussard*

D1-4: Recovery from Traumatic Injury: Facilitators, Barriers, and the Experience Expert—*Elizabeth Van Horn*

D1-5: Mass Casualty Care in an Expeditionary Environment: Developing Local Knowledge and Expertise in Context

—*Maria De Jong*

**Session D2: Living in the
Child's World**

MR 408

D2-1: Parent and Child Self-Reports of Effective Strategies to Promote Daily Adherence to Peak Flow Monitoring—*Patricia Burkhart*

D2-2: Patterns of Family Management of Childhood Chronic Conditions—*Kathleen Knaff*

D2-3: Figuring It Out: Parents' Reports of How They Help Their Toddlers with Down Syndrome Learn How to Eat Foods that Require Chewing—*Suzanne Thoyre*

D2-4: Discovering A Different Life Course: Children's Perceptions and Misconstructions of Chronic Illness—*Becky Christian*

D2-5: Children's Perceptions of Obesity Prevention—*Elaine Marshall*

**Session D3: The Challenge
of Balancing Energy**

SALON G

D3-1: What Were They Thinking? Cognitions While Using Monitoring Records to Solve Glycemic Control Problems—*Jo Azzarello*

D3-2: Comparison of Fitness Levels and Markers of Obesity in Apparently Healthy College Age Students—*Kathy Thornton*

D3-3: Depressive Symptoms and Food Energy Density are Independent Predictors of Abdominal Obesity
—*Daurice Grossniklaus*

D3-4: Effect of Obesity on CVD Risk Factors in African American Women
—*Queen Henry-Okafor*

D3-5: Cognitive Appraisal of Perceived Threat of Diabetes and Adherence to Self-Management Behaviors
—*Roger Carpenter*

Session D4: RIG-Sponsored Symposium: Community Health Bailouts! Diverse Approaches to Improving Health in Diverse Populations in Hard Economic Times

Symposium Leader: Janice Collins-McNeil
SALON K

D4-1: Methodology and Preliminary Findings of a Motivational Interview Intervention to Lower Diabetes Risk in African Americans
—*Carolyn Blue*

D4-2: Former Soviet Union Immigrant Women in Germany and the US Preventive Health Care Practices
—*Jie Hu*

D4-3: The Economic Impact of Gang Violence Prevention on Healthcare
—*Sarah Kelly*

D4-4: Older Nurses Experiences of Working with a Health Problem
—*Susan Lervak*

D4-5: Improving Health of the Latino/Hispanic Community
—*Debra Wallace*

Session D5: Symposium: Conducting Research after a Natural Disaster: Lessons Learned

Symposium Leader: Elizabeth Reifsnider
MR 404

D5-1: Protection of a Bio-Behavioral Lab: Lessons Learned from Hurricane Ike
—*Kyungeh An*

D5-2: The Impact of a Natural Disaster on Community-Based Intervention Research
—*Elizabeth Reifsnider*

D5-3: After the Storm: Where did all the Participants Go?
—*Yolanda Davis*

D5-4: Looking on the Bright Side of the Storm
—*Nonie Mendias*

Session D6: Symposium: Stress and Inflammation in Health and Disease

Symposium Leader: Duck-Hee Kang
MR 400

D6-1: Stress and Inflammation in Atherosclerosis: A Biobehavioral Approach
—*Duck-Hee Kang*

D6-2: Psychological Stress, Inflammation, and Women's Cancer Biobehavioral Research
—*Na-Jin Park*

D6-3: A Biobehavioral Approach to Stress and Inflammation in COPD
—*Charles Downs*

D6-4: Stress and Inflammation in Childhood Asthma: A Biobehavioral Approach
—*Anne Turner-Henson*

4:15 p.m.
Silent Auction Winners Posted
SALON J FOYER

4:15 p.m. – 4:45 p.m.
Break / Exhibits Open
SALON H FOYER / SALON J

4:45 p.m. – 6:00 p.m.
Session E1: Aging Ain't for Wimps or the Challenges to Healthy Aging
MR 400

E1-1: Nurses' Recognition of Delirium in the Hospitalized Older Adult: A Comparative Analysis of Nurse and Expert Diagnostician Ratings
—*Karen Rice*

E1-2: Symptom Distress, Depression, Functional Status, and Health-Related Quality of Life among Older Adults with Arthritis
—*Jeanne Jenkins*

E1-3: Determinants of Functional Status in Elderly Patients with Heart Failure
—*Jia-Rong Wu*

E1-4: Exploration of Informal Caregiving Following Hip Fracture
—*Eun-Shim Nahm*

Session E2: Dealing with Perinatal Loss
MR 404

E2-1: Moral Obligations in Newborn Intensive Care: Healthcare Provider Perspectives on the End of Life
—*Elizabeth Epstein*

E2-2: Perinatal Loss and Subsequent Birth
—*Deborah Armstrong*

E2-3: Explaining "Unexplained" Loss: Women's Experiences of One or More Perinatal Losses Associated with Antiphospholipid Syndrome
—*Susan Mathew*

E2-4: Predictors of Men's Depression and Grief at One Year after Miscarriage
—*Kristen Swanson*

Session E3: Poster Discussion Session #4 – Late Breakers
SALON K

E3-1: Effects of an Internship Program on Clinical Competence of Nursing Students
—*Shwu-Ru Liou*

E3-2: Advocacy from the Medical-Surgical Nurse Perspective: A Content Analysis
—*Robert Hanks*

E3-3: The Effect of ADN-BSN Partnerships for RN Mobility Enrollment and Graduation Rates
—*Ruby Morrison*

E3-4: Safe Practice Environments: Nurses' Perceptions of Stressors and Solutions
—*Peggy Landrum*

E3-5: Predictors of Home Health Nurses Changes in Practice after Experiencing Care Errors
—*Said Abusaleem*

E3-6: A Qualitative Study of Phlebotomy Device Selection
—*Jennifer Downing*

E3-7: Care of Central Venous Access Devices: A Pilot Study of Oncology Nurses' Troubleshooting Techniques—*Alice Boyington*

E3-8: Fall-Related Injuries in Older Adults: A Systematic Review of the Evidence—*Elizabeth Hill*

E3-9: The Impact of Project Lifesaver Program on Caregivers of Older Adults with Dementia—*Shu-li Chen*

E3-10: Obstructive Sleep Apnea Indicators and Injury in Older Farmers—*Karen Heaton*

E3-11: Health Promotion Interventions for Hispanic Family Caregivers—*Gayle Acton*

E3-12: Nurses' Knowledge and Attitudes toward Breastfeeding: Impact on Mothers'; Perception of Support—*Rebecca Clark*

E3-13: Disturbed Sleep and Risk Behavior in Low-Income Minority Teens—*Mary Umlauf*

E3-14: Hyperemesis Gravidarum and Mild Pregnancy-Related Nausea and Vomiting: A Comparative Study of the Physiological and Psychological Reactions and Birth Outcomes—*Fan-Hao Chou*

E3-15: Kitchen and Communication Equipment Use by Low Income Pregnant Women—*Cecilia Jevitt*

E3-16: Mi Chiquito (My Little One): Mothers of Mexican Heritage in the Neonatal Intensive Care Unit (NICU)—*Lisa Cleveland*

E3-17: Mechanisms of Intergenerational Transmission of Family Health Information—*Patricia Newcomb*

E3-18: Learning Motivation, Belief, and Attitude toward Science Learning of College Female Students in Taiwan—*Hsiu-Min Tsai*

E3-19: Sugar Mamas: The Impact of Caregiving Responsibilities on the Diabetic Health of African-American Primary Caregiving Grandmothers—*Dana Carthron*

E3-20: Secondhand Smoke Exposure and Birth Outcome in Jordan—*Linda Haddad*

E3-21: Difference in Smoking Identity and Smoking Behavior among College Students—*John Myers*

E3-22: Carnitine Plasma Levels in Children Receiving Chemotherapy—*Olga Taylor*

6:00 p.m. – 7:00 p.m.

RIG Meetings

Minority Health

MR 400

Academic Nurse-Managed Centers

MR 404

Ethics

MR 402

7:00 p.m. – 7:30 p.m.

Tear Down Poster Session II

SALON J

7:30 p.m.

Dinner on your own

7:30 a.m. – 8:00 a.m.
Poster Session III Setup
SALON J

7:30 a.m. – 8:30 a.m.
Continental Breakfast / Exhibits Open
SALON H / SALON J

7:00 a.m. – 7:45 a.m.
Funding Panel Breakfast
MR 406

7:00 a.m. – 12:00 p.m.
Registration Open
SALON J FOYER

8:00 a.m. – 8:30 a.m.
NIH Funding Mechanisms and New NIH Guidelines
SALON K
Speakers: *Paul Cotton and Xenia Tigno*,
NINR Program Directors

8:35 a.m. – 9:45 a.m.
Session F1: Improving Health in Communities
SALON F

F1-1: Development of a Culturally and Spiritually-Based Self-Management Curriculum for African Americans with Type 2 Diabetes—*Rebecca Casarez*

F1-2: Partnership Readiness for Community Based Participatory Research—*Jeanette Andrews*

F1-3: Smoke-Free Policy and Media Coverage in Rural Communities—*Ellen Hahn*

F1-4: Enhancement of an HIV Prevention Curriculum for Text Message Mobile Cell Phone Delivery with African American Youth—*Judith Cornelius*

Session F2: Supporting New Mothers
SALON G

F2-1: Healthy Eating in Low-Income, Pregnant, Anglo and Hispanic Women: Commonalities and Differences—*Eileen Fowles*

F2-2: The Nursing Support Intervention for African American Mothers of Prematures: Infant Health and Development Effects—*Diane Holditch-Davis*

F2-3: Effects of a Blended Infant-Massage/Parenting Enhancement Program on Recovering Substance-Abusing Mothers: Parenting Stress and Infant Safety—*Luz Porter*

F2-4: Urban Black Women's Preparation For Childbirth: A Grounded Theory—*Chris Abbyad*

Session F3: Symposium: Health Care Challenges of the Next Decade: Sleep Disturbances in Older Adults
Symposium Leader: Jean McSweeney
MR 404

F3-1: Objective Sleep, Insomnia Symptoms and Daytime Sleepiness in Older Women with Breast Cancer—*Carol Enderlin*

F3-2: A Description of Sleep in Persons with Dementia in the Nursing Home—*Melodee Harris*

F3-3: Relationships among Diagnosed Coronary Heart Disease Self-Reported Sleep Disturbance and Cognitive Impairment in Post-Menopausal Women
—Catherine Cole

F3-4: Severity of Sleep Apnea on Effects of Exercise and Social Activity in Persons with Dementia—Karen Rose

Session F4: Symposium: Asian Women's Health Research Network (Asia-Wh): Developing an International Collaborative Organization

Symposium Leader: Eun-Ok Im

MR 400

F4-1: Unexpected Challenges in Developing Asian Women's Health Research Network (ASIA-WH) in the U.S.—Eun-Ok Im

F4-2: The Process of Organizing the Asian Women's Health Research Network In South Korea
—Hung Sa Lee

F4-3: Strategies for Developing the Asian Women's Health Research Network (ASIA-WH) in Taiwan—Hsiu-Min Tsai

9:45 a.m. - 10:00 a.m.

Break / Exhibits Open
SALON H FOYER / SALON J

10:00 a.m. - 10:45 a.m.

Poster Session III with Authors

(* after author denotes Student Poster)

SALON J

PIII-1: Predictors of Mammography (MG) Adherence among American Indian Women; A Mixed-Methods Study
—Sara Baldwin

PIII-2: Factors Associated with Female Breast Cancer Recurrence: A Critical Review of the Literature
—Kristen Starnes-Ott*

PIII-3: Distress Associated with the Diagnostic Phase for Suspected Breast Cancer: A Systematic Review—Mariann Montgomery*

PIII-4: Effect of a Culturally Competent Diabetes Intervention on Diet in Black Women with Type 2 Diabetes—Allison Vorderstrasse

PIII-5: A Phenomenological Description of the Lived Experience of Creating Art for Women with Breast Cancer: Preliminary Findings—Laurie Stark*

PIII-6: Evaluation of Incentives to Increase Breast and Cervical Cancer Screening Rates
—Stephanie Marfurt

PIII-7: Determining the Efficacy of the Motivators to Achieve a Healthier Weight Interview Guide in Obese Older African American Women
—Pamela Bowen*

PIII-8: Distress in Women with Ovarian Cancer
—Judith Dellaripa*

PIII-9: Factors Which Influence Women's Decisions to Stop Smoking in Women with Known Coronary Heart Disease
—Leslie Moore*

PIII-10: Intimate Partner Violence, Treatment Adherence, and Disease Progression among HIV-Infected Women: A Pilot Study—Ma. de los Angeles Nava*

PIII-11: Maternal Relaxation Response and Skin-to-Skin Contact—Sheau-Huey Chiu

PIII-12: Identifying Mothers At-Risk: Factor Analysis of the Personal Support Matrix Score—Sandra Gossler

PIII-13: Perceived Maternal Competence among Low-Income, First-Time Mothers after Birth
—Debra Copeland

PIII-14: Maternal Well-Being and Preterm Infant Outcomes —Julie Strunk*

PIII-15: Safety and Efficacy of a Touch and Massage Intervention: NICU-PLAY—Jacqueline McGrath

PIII-16: Informed Decision Making in Prenatal Genetic Testing: A Review of the Literature—Mandeep Kaur*

PIII-17: Neighborhood Characteristics in a Sample of Mothers of Preterm Infants—Lois Phillips*

PIII-18: Nursing Faculty Shortage: Nurses' Perceptions of Solutions
—Evelyn Klocke*

PIII-19: Perceptions of Work Engagement and Nurses in Taiwan: Preliminary Findings—Meiling Wu*

PIII-20: Clinical Simulation and Student Outcomes: A Pilot Study—Ramona Parker

PIII-21: Developing Novice Faculty: Educator Competencies for Simulation—Jeanette McNeill

PIII-22: Assessing Retention of Knowledge of Ovarian Cancer in Baccalaureate Nursing Students
—Victoria Loerzel

PIII-23: Predictors of Success among Caucasian and Hispanic Students in Traditional and Accelerated Nursing Programs
—Andrea Berndt

PIII-24: A Comparative Study to Determine if Diverse Students in a Program Promoting Cultural Competence Become Culturally Proficient
—Lauren Viego*

PIII-25: Twelve-Hour Clinical Rotations and Their Effect on Continuity of Care Provided by New Graduates of an Accelerated BSN Program—Linda Crumpton*

PIII-26: Attitudes of Health Care Professions Faculty Toward Interprofessional Education—Laura Petri

PIII-27: Community-Based Participatory Research: Approaching Mental Health among Low-Income Latinos in Rural Areas
—Jeanne-Marie Stacciarini

PIII-29: Considerations for Selecting Software Packages for Measuring Heart Rate Variability—*Jeongok Logan**

PIII-30: The Effects of an Evidence-Based Intervention on Stress and Coping of Families of Critically Ill Trauma Patients—*Sandra Knapp**

PIII-31: Using the Evidence to Create an Education Tool for the Low Literacy Patient—*Karen Stonecypher**

PIII-32: Integrated Review of Medication Adherence in Hispanics with Latent Tuberculosis (1998-2009)—*Julie Zuniga**

PIII-33: Demographic and Clinical Characteristics of the Home Health Care Heart Failure Patient Population—*Jennifer Riggs**

PIII-35: Using an Internet Protocol to Gather Stories for Qualitative Research with Individuals Living Through Health Challenges—*Margaret Rateau**

PIII-36: A Pilot Study to Explore the Prevalence of Type 2 Diabetes, Diabetes-Related Risk Factors, and Diabetes Knowledge in a Rural Latino Population—*Karen Amirehsani**

PIII-37: Nursing Interventions for Improving HIV Medication Adherence—*Philip Davis**

PIII-38: Inflammatory Proteins, Genetic Variation, and Environmental Influences on Nosocomial Infection Development in Sepsis Patients—*Reba Umberger**

PIII-39: The Experience of Being Discharged Alive from Hospice as Perceived by Older Adults—*Rebeka Watson Campbell**

PIII-40: The -844 A>G - 4G/5G - HindIII Haplotype at the PAI-1 Locus is Associated with Variable Levels of LDL among Caucasians and African American Women—*Susan Appel*

PIII-41: Information Literacy Programs for Evidence-Based Practice—*Patricia Lafferty**

PIII-42: Review of the Roles and Activities of Community Health Advisors in Diabetes Care—*Caralise Hunt**

PIII-43: Perceived Barriers to HIV Care among HIV, Women in the Deep South—*Jenn McLeod*

PIII-44: Health Behaviors among Women Living with HIV: What is the Efficacy of a Tailored Health Promotion Program?—*Aviva Rubin**

PIII-46: Risk Associations Between Perceived Stress, Insulin Resistance and Allostatic Load among Non-Diabetic African American Women of the Jackson Heart Study—*Alethea Hill**

PIII-47: All-Terrain Vehicle Use on Hobby and Commercial Farms—*Sarah Cole**

PIII-48: Identifying Environmental Influences on Obesity Risk Factors of Commercial Truck Drivers—*Lisa Turner**

PIII-49: Predictors of Obesity and Fat-Related Diet Habits among Police Officers—*Rebecca Grizzle*

PIII-50: Exploring the Stress Response in New Army Nurses—*Laureen Otto**

PIII-51: The Effect of Combat Exercises on Cardiovascular Response: An Exploratory Study—*MeLisa Gantt**

PIII-52: Managers' Perspectives about Oncology Nurses' Use of Hazardous Drug Safe Handling Precautions—*Martha Polovich**

PIII-53: A Systematic Review of the Literature: Workplace Violence in the Emergency Department—*Jessica Taylor**

PIII-54: Perceptions and Experiences of Diabetes Self-Management among Diabetic Migrant Farm Workers during Migration—*Heather Cuevas**

PIII-55: Reported Health Status and Access to Care for Diabetes Patients: A Secondary Analysis—*Jennifer Veshnesky**

10:45 a.m. - 12:00 p.m.

Session G1: Monitoring the Work Environment

MR 400

G1-1: Off-Peak Hospital Work Environments and their Effect on Nurses' Work: An Institutional Ethnography—*Patti Hamilton*

G1-2: Nursing Staff Mix and Nursing Home Quality—*Mark Toles*

G1-3: International and US Educated Nurse Perceptions of the Work Environment and Nurse Outcomes—*Donna Neff*

G1-4: Measuring Nursing Time Allocation with Real Time Location System Technology (TRLs): Strengths and Limitations—*Terry Jones*

Session G2: Challenges in Cognition

MR 404

G2-1: Patterns of Cerebral Oxygen during Sleep and Two-Year Functional Decline in Elders, Age 70 Years and Older—*Barbara Carlson*

G2-2: Exploring the Meaning and Behaviors of Critical Thinking in Nursing Practice—*Helene Hakim*

G2-3: Improving Speed of Processing Functioning in Adults with HIV: A Pilot Study—*Carrie Long*

G2-4: Therapeutic Computer Activity Intervention in Persons with Dementia—*Sunghee Tak*

Session G3: Dealing with Stress and Anxiety

SALON F

G3-1: Stress Management in Women Newly Diagnosed with Breast Cancer: Preferred Method, Efficacy, and Impact of Practice on Immune Responses
—*Duck-Hee Kang*

G3-2: The Severity of Addiction for Individuals Entering Therapeutic Community Treatment
—*Deida Carroll*

G3-3: Spielberger's State Anxiety Inventory: The Development of a Shortened Version for the Critically Ill—*Mona Abed*

G3-4: Pre-Migration Persecution, Post-Migration Stressors and Resources, and Post-Migration Mental Health: A Study of Traumatized U.S. Arab Immigrant Women
—*Anne Norris*

Session G4: Symposium: J.A. Hartford Fellows and Scholars: Challenges of Caring for Aging Baby Boomers

SALON G

G4-1: Older Black and White Women's Cardiac Risk Perceptions—*Leanne Lefler*

G4-2: Health Needs of Vietnamese American Elders—*Nancy Chu*

G4-3: Overcoming the Challenge of Promoting Personhood among Nursing Home Residents Living with Dementia
—*Bill Buron*

G4-4: Predictive Variables of Sleep Disturbances in Older Adults—*Karen Rose*

11:00 a.m. – 1:00 p.m.
Tear Down Poster Session III
SALON J

University of Texas at Austin

Awards Luncheon

In 1974 The University of Texas at Austin School of Nursing was one of the first nursing schools to begin a PhD program. It has since grown to become the leading research-extensive school of nursing in Texas and is ranked among the top 20 nursing graduate programs in the nation."

The University of Alabama at Birmingham School of Nursing

Networking Break

The University of Alabama at Birmingham School of Nursing prepares nurse leaders to excel as clinicians, researchers, and educators through cutting-edge bachelor, master's and doctoral programs. The School is a leader in collaborative science and partners with over 22 university-wide interdisciplinary research centers, including a Center for Clinical and Translational Science.

University of Florida College of Nursing

Networking Break

The University of Florida College of Nursing is recognized nationally for innovative education, dynamic programs of research and creative approaches to nursing practice. Offering baccalaureate, master's and doctoral degrees, UF nursing education programs produce leaders, scholars and clinicians who promote quality patient care and influence health policy.

University of Alabama at Birmingham

Networking Break

The University of Alabama at Birmingham School of Nursing prepares nurse leaders to excel as clinicians, researchers, and educators through cutting-edge bachelor, master's and doctoral programs. The School is a leader in collaborative science and partners with over 22 university-wide interdisciplinary research centers, including a Center for Clinical and Translational Science.

Johns Hopkins University School of Nursing

Conference Tote Bags

The Johns Hopkins University School of Nursing is a global leader in nursing research, education, and scholarship. The School and its academic programs are recognized for excellence in educating nurses who set the highest standards for patient care and become innovative national and international leaders. For more information, visit <http://www.nursing.jhu.edu>.

The University of Oklahoma College of Nursing Donald W. Reynolds Center of Geriatric Nursing Excellence

Lanyards

The University of Oklahoma College of Nursing Donald W. Reynolds Center of Geriatric Nursing Excellence is committed to increasing the number of highly-qualified faculty with expertise in geriatrics who will provide academic leadership in geriatric nursing within Oklahoma, with emphasis on successful community-based aging in place.

2010 SNRS Award Winners

John A. Hartford Foundation Geriatric Research Award:
Ruth M. Tappen, EdD, RN, FAAN

Distinguished Researcher Award:
Sandra B. Dunbar, RN, DSN, FAAN

Researcher in Minority Health:
Randy A. Jones, PhD, RN
Leadership in Research:
D. Patricia Gray, PhD, RN

Exhibitors

2010 Exhibit Hall Schedule

Wednesday, February 3, 2010

2:00 p.m. – 5:00 p.m. Decorator Setup
5:00 p.m. – 10:00 p.m. Exhibitor Move-in

Thursday, February 4, 2010

7:30 a.m. – 8:30 a.m. Continental Breakfast/Exhibits Open
9:45 a.m. – 10:15 a.m. Break/Exhibits Open
11:30 a.m. – 1:30 p.m. Exhibits Open
3:00 p.m. – 3:30 p.m. Break/Exhibits Open
4:45 p.m. – 7:30 p.m. Exhibits Open
7:30 p.m. Exhibits Close

Friday, February 5, 2010

7:30 a.m. – 8:15 a.m. Continental Breakfast/Exhibits Open
10:45 a.m. – 11:00 a.m. Break/Exhibits Open
2:00 p.m. – 2:45 p.m. Exhibits Open
4:15 p.m. – 4:45 p.m. Break/Exhibits Open
6:00 p.m. Exhibits Close

Saturday, February 6, 2010

7:30 a.m. – 8:30 a.m. Continental Breakfast/Exhibits Open
9:45 a.m. – 10:00 a.m. Break/Exhibits Open
11:00 a.m. – 1:00 p.m. Exhibitor Tear Down

American Nurses Foundation

8515 Georgia Ave, #400, Silver Spring, MD 20910

Phone: (301) 628-5229

denise.mahone@ana.org

Since 1955, the American Nurses Foundation (ANF) has created opportunities for nurses and impacted lives through nursing research grants and funding that advances the nursing profession and enhances the health of the public. As the philanthropic and charitable arm of the American Nurses Association (ANA), donations to ANF are tax-deductible.

Table Top: 7

Boise State University

1910 University Drive, Boise, ID 83725

Phone: (208) 426-2210

jeribigbee@boisestate.edu

As a premier school of nursing in the Intermountain West, Boise State University Department of Nursing is recognized for outstanding teaching, research, and a commitment to service. Academic programs include a BSN, RN to BS Completion, and MSN in population health nursing, with opportunities for international teaching and research.

Table Top: 3

The Capstone College of Nursing at the University of Alabama

Box 870358, Tuscaloosa, AL 35487-03582

Phone: (205) 348-3361

odom015@bama.ua.edu

The Capstone College of Nursing is committed to the provision of excellent nursing education at both the undergraduate and graduate levels. The College's commitment is demonstrated by an undergraduate and graduate curriculum that is responsive to changes in the health care system.

Fax: (205) 348-5559

<http://www.nursing.ua.edu>

Table Top: 14

Emory University, School of Nursing

1520 Clifton Road, NE, Atlanta, GA 30322

Phone: (404) 727-6923

aharrel@emory.edu

Emory University's PhD in Nursing is committed to improving human health, the experience of health, and the provision of health care through the discovery of new knowledge and its translation into practice. Visit our booth to pick up information and a program brochure.

Table Top: 16

Fax: (404) 727-0536

www.nurse.emory.edu/phd

Johns Hopkins University, School of Nursing

525 N. Wolfe St, Baltimore, MA 21205

Phone: (410) 955-7548

dalton@jhu.edu

Johns Hopkins University School of Nursing offers academic preparation for the future leaders in the profession of nursing to practice in national and international settings. Degreeed programs include Baccalaureate, Master's and Doctoral education. Areas of focus include, but are not limited to Forensic Nursing, Nurse Practitioner, MSN/MBA, MSN/MPH, DNP & PhD. www.nursing.jhu.edu

Table Top: 15

Fax: (410) 614-7086

www.son.jhmi.edu

Medical College of Georgia, School of Nursing

987 St. Sebastian Way, EC5426, Augusta, GA 30912

Phone: (706) 721-2787

ghathorn@mcg.org

<http://www.mcg.edu/son/>

Medical College of Georgia School of Nursing, the University System of Georgia's flagship nursing school, offers programs in: Baccalaureate Nursing, Nursing Anesthesia, Clinical Nurse Leader (for non-nurses seeking second degree), RN to MSN (CML), Nurse Practitioner (family and pediatric), Doctor of Nursing Practice, and Doctor of Philosophy in Nursing

Table Top: 1

Fax: (706) 721-1878

<http://www.mcg.edu/son/>

National Institute of Nursing Research

31 Center Drive, Room 5B-10, Bethesda, MD 20892-2178

Phone: (301) 496-0208

barrettmg@mail.nih.gov

The National Institute of Nursing Research (NINR), a component of the National Institutes of Health, supports basic and clinical research that develops the knowledge to build the scientific foundation for clinical practice, prevent disease and disability, manage and eliminate symptoms caused by illness, and enhance end-of-life and palliative care.

Table Top: 2

Fax: (301) 480-8845

www.ninr.nih.gov

Nurse Oncology Education Program

7600 Burnet Rd, Suite 440, Austin, TX 78757

Phone: (512) 467-2803 ext 164

cwells@texasnurses.org

NOEP provides evidence-based continuing education to nurses in all fields of practice on cancer prevention, detection, treatment, and survivorship. NOEP is a nonprofit project of the Texas Nurses Association/Foundation and funded by the Cancer Prevention and Research Institute of Texas.

Table Top: 12

Fax: (512) 467-0834

www.noeptexas.org

Sigma Theta Tau International

550 W North St, Indianapolis, IN 46202

Phone: (317) 917-4930

jackie@stti.iupui.edu

Through members, chapters and communities of practice, the Honor Society of Nursing, Sigma Theta Tau International supports the learning, knowledge and professional development of nurses who strive to improve the health of the world's people.

Booth: 104

Fax: (317) 686-7306

[www.http://www.nursingsociety.org](http://www.nursingsociety.org)

Exhibitors

Texas Tech University Health Sciences Center Booth: 108

Anita Thigpen Perry School of Nursing, 3601 4th St, Stop 6264, Lubbock, TX 79430
Phone: (806) 743-2751 Fax: (806) 743-1648
aricka.cano@ttuhsc.edu www.ttuhsc.edu/son/

The primary mission of Texas Tech University Health Sciences Center Perry School of Nursing is to provide quality educational programs and advance excellence in health care for diverse populations through programs of scholarship, research, practice, and service. We offer several different programs in which you can obtain your BSN, MSN, and even DNP.

Texas Woman's University, College of Nursing Booth: 106

PO Box 425498, Denton, TX 76204
Phone: (940) 898-2401 Fax: (940) 898-2437
ddurance@twu.edu www.twu.edu

Texas Woman's University College of Nursing is committed to preparing professional nurses to work in a variety of settings. Our BS, MS, DNP and PhD programs are designed for students to develop knowledge, clinical skills and research opportunities on our Denton, Dallas and Houston campuses and online.

Tri Service Nursing Research Program Table Top: 11

4301 Jones Bridge Road, Bethesda, MD 20814
Phone: (301) 319-0598 Fax: (301) 319-0603
mburcroff@usuhs.mil http://www.usuhs.mil/tsnrp/

TriService Nursing Research Program (TSNRP) is the United States' first and only Federal program promoting military nursing research. TSNRP provides grant writing and publication workshops and awards research grants to qualified Nurse Corps officers in the Army, Navy, Air Force, and National Guard.

University of Alabama at Birmingham, School of Nursing Table Top: 6

1530 3rd Avenue South; NB 208A, Birmingham, AL 35294-1210
Phone: (205) 934-5491
Fax: (205) 934-5490
jacobsen@uab.edu
www.http://main.uab.edu/Sites/nursing/

The UAB School of Nursing offers innovative bachelor's, master's, and doctoral programs. Among these are the state's only PhD in Nursing and joint Doctor of Nursing Practice (DNP) degrees, more than 10 specialty and/or subspecialty nurse practitioner and clinical nurse specialist majors, dual degree options, and advanced majors in administration and informatics.

University of Arkansas, Eleanor Mann School of Nursing Table Top: 17

217 Ozark Hall, Fayetteville AR 72701
Phone: (479) 575-5871 Fax: (479) 575-3218
kbarta@uark.edu www.http://nurs.uark.edu

The University of Arkansas School of Nursing offers a traditional undergraduate BSN program and an online graduate MSN program to prepare clinical nurse specialists in Adult Health. Plans are underway to double the undergraduate enrollment to coincide with the opening of a new nursing building scheduled for completion in 2012.

University of Florida, College of Nursing Table Top: 9

PO Box 100197, Gainesville, FL 32610
Phone: (352) 273-6321 Fax: (352) 273-6573
ahorgas@ufl.edu http://www.con.ufl.edu

The University of Florida College of Nursing is recognized nationally for innovative education, dynamic programs of research and creative approaches to nursing practice. Offering baccalaureate, master's and doctoral degrees, UF nursing education programs produce leaders, scholars and clinicians who promote quality patient care and influence health policy.

University of Kentucky, College of Nursing Booth: 105

315 CON Bldg, 751 Rose St, Lexington, KY 40536-0232
Phone: (859) 323-5108 Fax: (859) 323-1057
megreg3@email.uky.edu www.mc.uky.edu/nursing

The University of Kentucky College of Nursing offers a full complement of programs, including a traditional BSN, RN-BSN, Second Degree BSN, a new BSN-DNP Option, BSN-PhD Option, DNP and PhD, as well as an active continuing education program. Our goal is to help you realize yours. Visit us at www.mc.uky.edu/nursing

University of Maryland, School of Nursing Table Top: 18

655 West Lombard Street, Suite 311
Baltimore, MA 21201
Phone: (410) 706-4122 Fax: (410) 706-5560
doerr@son.umaryland.edu http://nursing.umaryland.edu/

The University of Maryland School of Nursing develops strong leaders who shape the profession of nursing and have a powerful impact on the health care environment. The concepts of leadership, partnership, and innovation are fundamental to all of the School's academic, research and clinical initiatives.

University of Miami, School of Nursing and Health Studies Table Top: 10

PO Box 248153, Coral, FL 33124-3850
Phone: (305) 284-4732
kdeltoro@miami.edu
http://www6.miami.edu/sonhs/

The University of Miami School of Nursing and Health Studies offers the resources of a top research university: renowned faculty, cutting-edge programs, diverse clinical experiences, state-of-the-art facilities, and affiliation with a major academic medical center. Our degree programs include BSN, BSHS, MSN, DNP, and PhD. Located in the center of a dynamic international community, students receive the education needed for success in today's diverse health care environment.

University of North Carolina - Chapel Hill, School of Nursing Table Top: 5

1200 Carrington Hall, CB 7460, Chapel Hill, NC 27599-7460
Phone: (919) 966-4260 Fax: (919) 966-3540
jennifer.i.moore@unc.edu www.http://nursing.unc.edu/

The UNC-Chapel Hill School of Nursing, renowned for its academics, research and state, national and global service, offers baccalaureate through doctoral nursing education, producing nurses prepared to meet the challenges of an ever-changing healthcare system.

Exhibitors

University of South Florida, College of Nursing

Booth: 103

12901 Bruce B. Downs Blvd, MDC 22, Tampa, FL 33612

Phone: (813) 396-9936

mparker@health.usf.edu

www.health.usf.edu/nursing

The University of South Florida College of Nursing is a member of USF Health, a collaborative enterprise dedicated to making life better through research, education, and healthcare. We offer a wealth of options including BS, MS, PhD, and DNP programs. For more information, contact us at (813) 974-2191 or www.health.usf.edu/nursing.

The University of Tennessee, College of Nursing

Table Top: 13

1200 Volunteer Blvd, Knoxville, TN 37996

Phone: (865) 974-7583

Fax: (865) 974-3569

sgossler@utk.edu

The University of Tennessee, Knoxville College of Nursing is located on the flagship campus of the UT System and offers programs leading to the BSN, MSN and PhD degree. The College's Center for Health Science Research includes studies focusing on HIV/AIDS, aging, mental health, recovery from trauma, women's health, nursing care quality, and related topics.

The University of Texas at Austin, School of Nursing

Table Top: 4

1700 Red River, Austin, TX 78701

Phone: (512) 471-7311

Fax: (512) 471-4910

<http://www.utexas.edu/nursing/>

In 1974 The University of Texas at Austin School of Nursing was one of the first nursing schools to begin a PhD program. It has since grown to become the leading research-extensive school of nursing in Texas and is ranked among the top 20 nursing graduate programs in the nation.

University of Texas Medical Branch, School of Nursing

Table Top: 8

301 University Blvd., Galveston, TX 77555-1029

Phone: (409) 772-8262

Fax: (409) 747-1554

elreifs@utmb.edu

www.son.utmb.edu

UTMB's SON provides scholarly teaching; state-of-the-art, culturally relevant care; and innovative research that contributes to the improvement of health. We conduct research in aging, maternal/child health, nutrition and physical activity, and stress and coping. Our educational programs include three routes to the BSN, seven MSN programs, and a Nursing PhD.

West Virginia University, School of Nursing

Booth: 107

Room 6415 Health Sciences South, PO Box 9600, Morgantown, WV 26506-9600

Phone: (304)-293-1386

Fax: (304) 293-2784

swells@hsc.wvu.edu

www.hsc.wvu.edu/son/

The West Virginia University School of Nursing's innovative educational offerings include live, interactive, online delivery of the Master of Science in Nursing and Doctor of Nursing Practice programs. Students participate in class from anywhere in the world. Our unique summer-residency program for the PhD in nursing is ideal for nurse educators.

“If nursing is your life,
then USF is for you.”

The College of Nursing is an integral part of USF Health as well as the larger University of South Florida, and has access to an extensive array of resources and collaborations for research. With over \$300 million in research funding last year, USF is ranked one of the nation's top 63 public research universities. As a community engaged public university of growing state, national and global impact, The Carnegie Foundation for the Advancement of Teaching has classified USF as a RU/VH: Research Universities (very high research activity) one of three Research 1 Universities in the Florida State University System.

Graduate Programs:

- Doctoral
- BS to PhD
- MS to PhD
- DNP
- Masters
- Nurse Practitioner
- Nurse Anesthesia
- Clinical Nurse Leader
- Nurse Educator

Faculty Opportunities:

Opportunities for faculty positions are available at all levels and we welcome your inquires.



**University of South Florida
College of Nursing**

University of South Florida College of Nursing
12901 Bruce B. Downs Blvd., MDC 22 Tampa, FL 33612
(813) 974-7863
health.usf.edu/nursing
For Faculty Opportunities Visit: <http://employment.usf.edu>

Schedule at a glance

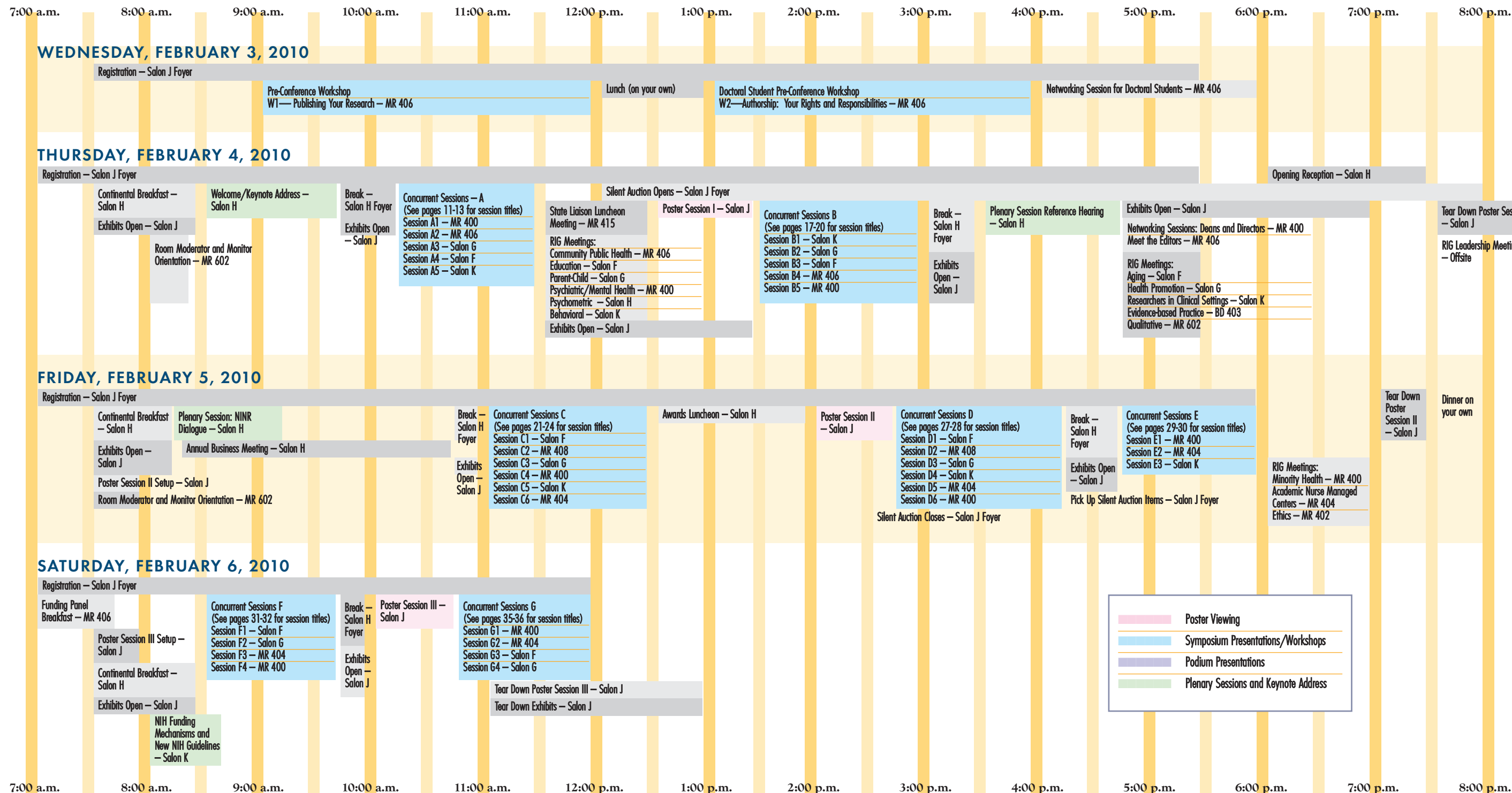

Poster Viewing

Symposium Presentations/Workshops

Podium Presentations

Plenary Sessions and Keynote Address